

L - LOFT
 B - BLOCK
 # - SHEAVE DIAMETER
 -
 F - BEAM FLANGE MOUNTING
 # - NUMBER OF GROOVES
 N - SHEAVE MATERIAL (N=NYLATRON, S=STEEL)
 # - ROPE SIZE

MODEL	CAPACITY	DIM A	WEIGHT
LB12-F1N25	875 LBS	2.50 [64mm]	30.00 LBS
LB12-F2N25	875 LBS	2.50 [64mm]	29.88 LBS
LB12-F3N25	875 LBS	2.91 [74mm]	31.74 LBS
LB12-F4N25	875 LBS	3.34 [85mm]	33.77 LBS
LB12-F5N25	875 LBS	3.78 [96mm]	35.81 LBS
LB12-F6N25	875 LBS	4.22 [107mm]	37.86 LBS
LB12-F7N25	875 LBS	4.66 [119mm]	39.90 LBS
LB12-F8N25	875 LBS	5.09 [130mm]	41.99 LBS
LB12-F9N25	875 LBS	5.53 [141mm]	44.04 LBS
LB12-F1N38	875 LBS	2.69 [69mm]	30.76 LBS
LB12-F2N38	875 LBS	2.69 [69mm]	29.90 LBS
LB12-F3N38	875 LBS	3.34 [85mm]	33.51 LBS
LB12-F4N38	875 LBS	3.78 [96mm]	35.45 LBS
LB12-F5N38	875 LBS	4.66 [119mm]	39.51 LBS
LB12-F6N38	875 LBS	5.09 [130mm]	41.50 LBS
LB12-F7N38	875 LBS	5.53 [141mm]	43.43 LBS
LB12-F8N38	875 LBS	5.97 [152mm]	45.35 LBS
LB12-F1S25	875 LBS	2.50 [64mm]	44.84 LBS
LB12-F2S25	875 LBS	2.50 [64mm]	44.03 LBS
LB12-F3S25	875 LBS	2.91 [74mm]	44.19 LBS
LB12-F4S25	875 LBS	3.34 [85mm]	47.50 LBS
LB12-F5S25	875 LBS	3.78 [96mm]	50.82 LBS
LB12-F6S25	875 LBS	4.22 [107mm]	54.15 LBS
LB12-F7S25	875 LBS	4.66 [119mm]	57.47 LBS
LB12-F8S25	875 LBS	5.09 [130mm]	60.83 LBS
LB12-F9S25	875 LBS	5.53 [141mm]	64.17 LBS
LB12-F1S38	875 LBS	2.69 [69mm]	46.88 LBS
LB12-F2S38	875 LBS	2.69 [69mm]	44.62 LBS
LB12-F3S38	875 LBS	3.34 [85mm]	45.71 LBS
LB12-F4S38	875 LBS	3.78 [96mm]	48.30 LBS
LB12-F5S38	875 LBS	4.66 [119mm]	54.76 LBS
LB12-F6S38	875 LBS	5.09 [130mm]	57.45 LBS
LB12-F7S38	875 LBS	5.53 [141mm]	59.95 LBS
LB12-F8S38	875 LBS	5.97 [152mm]	62.42 LBS

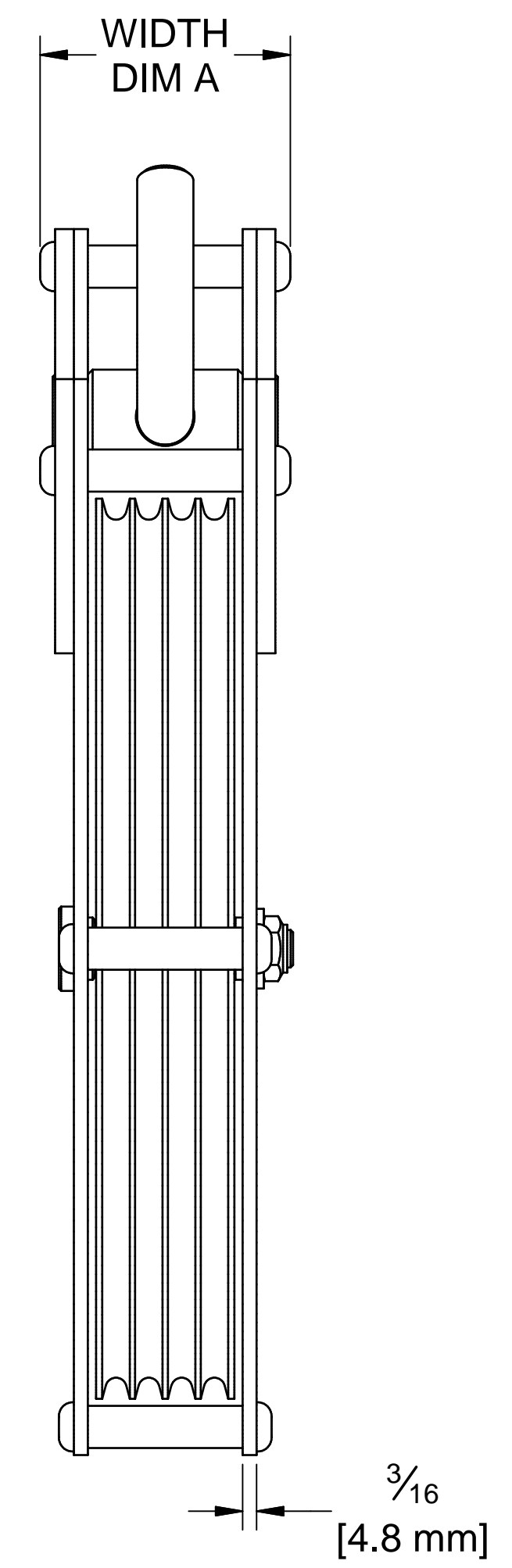
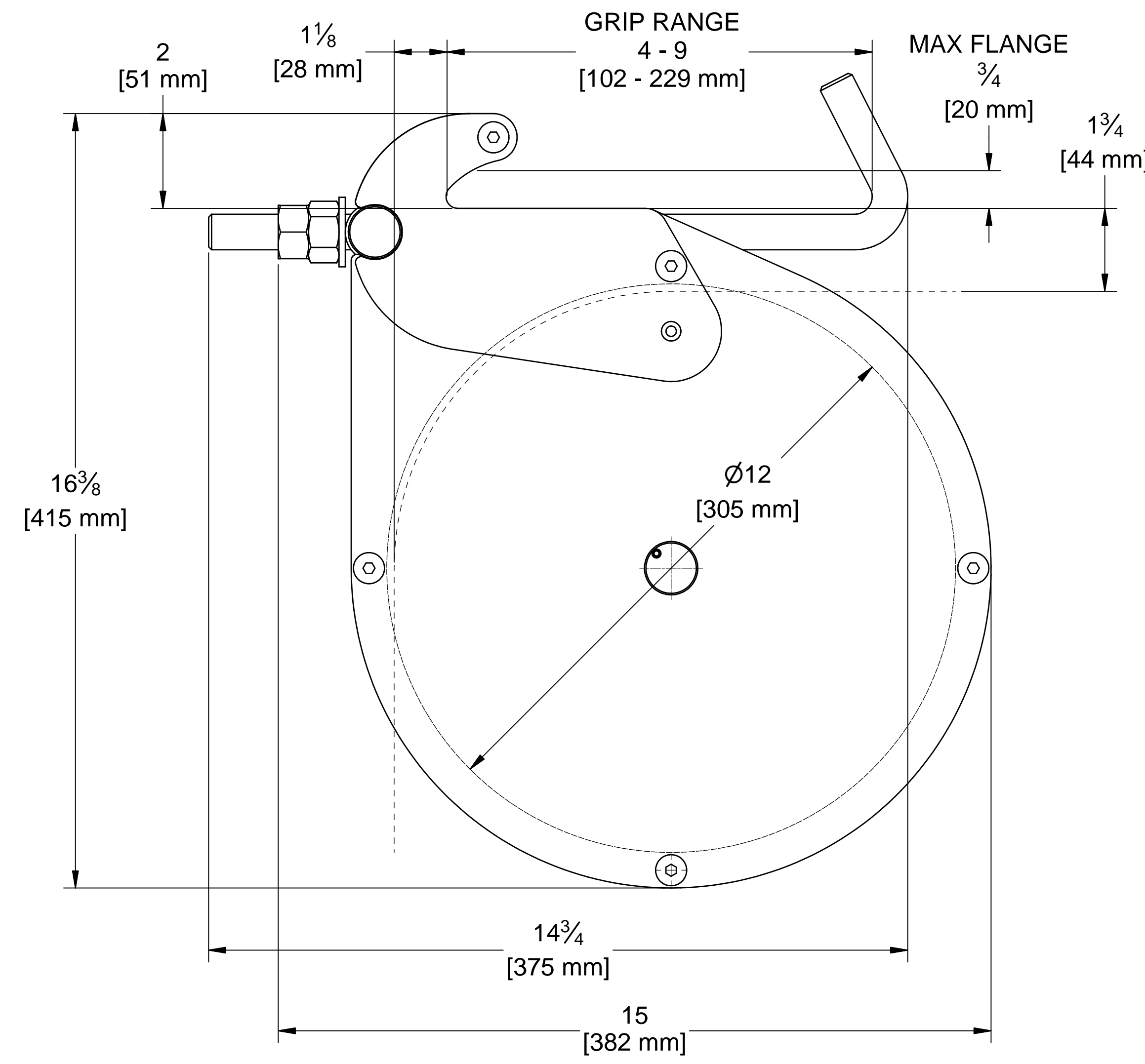

NOTES:
 1. MAXIMUM RATED CAPACITY :
 - MAY EXCEED CAPACITY OF THE ROPE.
 USE ROPE MANUFACTURER'S RATING AND SAFETY FACTOR TO DETERMINE LOAD LIMIT.
 - WHEN PROPERLY INSTALLED, MAINTAINED AND OPERATED.
 - IS BASED ON CABLES WRAPPED 90 DEGREES AROUND THE SHEAVE.
 2. CONTACT FACTORY FOR NON-STANDARD REQUIREMENTS.

DRAWINGS FOR PRODUCTION APPROVAL. MANUFACTURE WILL NOT BEGIN UNTIL APPROVED DRAWING IS RETURNED TO THERN INC.		COMPANY NAME _____ PRINT NAME _____ SIGNATURE _____ DATE _____	
DIMENSIONAL DRAWING		 5712 INDUSTRIAL PARK ROAD P.O. BOX 347 WINONA, MN 55987 PHONE 1-507-454-2996 FAX 1-507-454-5292	
TOLERANCES UNLESS OTHERWISE SPECIFIED FRAC. ± 1" ANG. ± 5° DO NOT SCALE DRAWING	THIS PRINT IS THE PROPERTY OF THERN, INC. AND MUST NOT BE REPRODUCED EITHER IN FULL OR IN PART WITHOUT WRITTEN APPROVAL BY THERN, INC.	WEIGHT SEE TABLE DRAWN BY JCA SCALE NTS DATE 9/28/2015	PART NO D4479 SHEET 3 OF 3